

## Bulkhead Receptacle CRA2154

Bulkhead Receptacle CRA2154 was developed for military and commercial in response to the need for a highly reliable underwater coax connection. Its glass-to-metal seal readily withstands face pressures up to 10,000 psi. CRA2154 is available in kit form, as well as pre-assembled to any coax cable selected.

CRA2154 mates to any CPA2155 or CPA2902 connector. The accessory sealing plug for CRA2154 is SP2417.



### Order as P/N: CRA2154-X-Y-Z

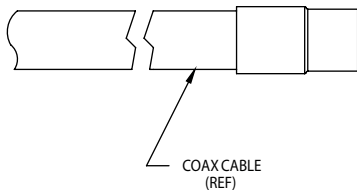

X = Form Code  
See Table 1



Y = Cable Code  
See Table 2

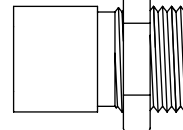

9/16 X 18  
UNF-2A THREADS.

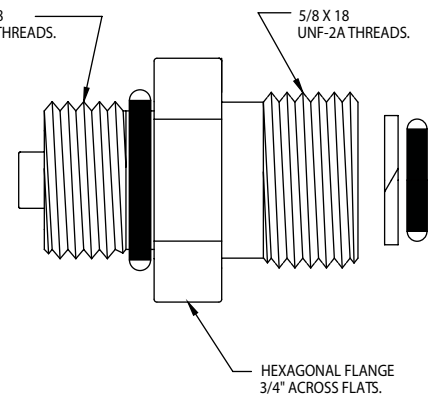

HEXAGONAL FLANGE  
3/4" ACROSS FLATS.

Z = Cable Length In Feet  
Use "0" If Ordering As Kit

Characteristic Impedance	Insulation Resistance	Frequency Range	Dielectric Withstand Voltage	Pressure Rating	Material
50 Ohms	5000 MΩ @500VDC	DC to 3 GHz (depends on cable selection)	1000V (RMS) 60 Hz	10,000 psi	316/316L Stainless Steel